

- CONTACT US-

ADD: 5/26 Ryelane Street Maddington, WA 6109

Mobile: 0404 610 598

E-mail: jqtradinggroup@gmail.com

Web: www.jqgroup.com.au

JQ TRADING GROUP PTY LTD

**5/26 RYELANE STREET MADDINGTON,
WA 6109**



Company Profile

CANGZHOU DUOTONG METAL PRODUCTS Co., Ltd., founded in 2014, is a leading manufacturer specializing in malleable iron pipe fittings. With a strong emphasis on quality control, innovation, and customer satisfaction, we serve clients across China and export to regions including North America, Europe, Southeast Asia, the Middle East, and Africa.

To strengthen our presence in the Australian market, we work in partnership with J&Q Trading Group Pty Ltd, our exclusive distributor in Australia. J&Q Trading Group focuses on delivering our high-quality pipe fittings to Australian clients, offering both OEM and ODM solutions. Their local expertise ensures responsive service, faster delivery, and tailored support for a wide range of customer needs.

Together, we are committed to providing reliable products, competitive pricing, and long-term value to our partners in Australia.

Malleable iron Pipe Clamps

Material

Malleable iron Pipe Clamps are designed by using malleable iron in accordance with ASTM A197 which applies for good mechanical strength and enough elongation characters. The surface treatment of the clamps is hot dipped galvanized which meet the specification of ASTM A153 to anti-rusting and corrosion. Or according to end-users requirements to match different circumstance.

Size

Six different sizes are available as following, By using the product code along with the size code will be easily identify the single clamp between both.

Pipe Clamp Size	Nominal Bore	Outside Diameter
S	3/8"	17.2mm
T	1/2"	21.3mm
A	3/4"	26.9mm
B	1"	33.7mm
C	1-1/4"	42.4mm
D	1-1/2"	48.3mm
E	2"	60.3mm

Applications

Pipe Clamps are widely used in hand railing safety guard railing situations. The system securely joins standard sizes of structural steel tube into almost any configuration imaginable.

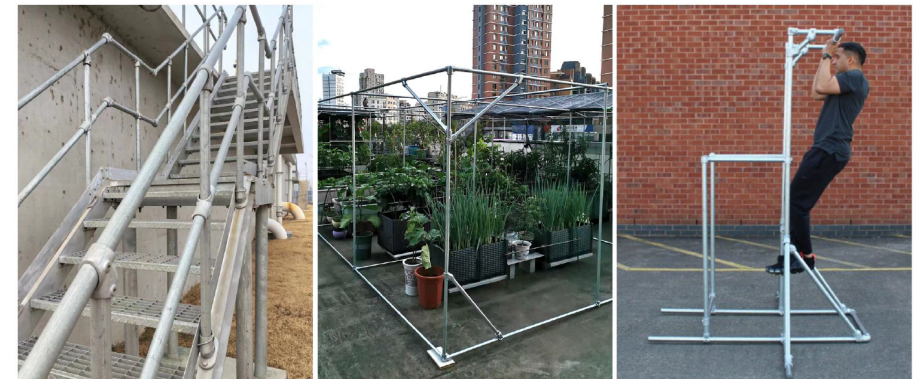

KEY CLAMP PIPE FITTINGS

An indication of typical applications

Handrails, Fences & Security Fencing, Playground Equipment, Milking Parlours, Railway Guardrailing, Garment Racking, Market Stalls, Cycle Racks & Trolley Bays, Sports Practice Nets (Golf, Cricket, Baseball, Football etc.) Sports Grounds & Arenas, Machinery Guards & Enclosures, Motorway Control installations, Road Signs, Roof top Fall Prevention Systems, Heavy Duty Workstations, Safety Guardrails, Retail Displays & Shopfitting, Racking, Agricultural Enclosures, Greenhouses, Exhibition stands & displays, Industrial & Domestic Furniture, Temporary Buildings, Wheelchair Access Ramps, Theme Park Queue Management, Canopies & Car Ports, Lighting Supports, Roof Guardrails, Film sets, Cable reels, General Signage, Civic Amenity, Recycling Sites, Shipbuilding, Access Platforms, Mezzanine Floors, Water Treatment Works, Staircase Handrails, Commercial Billboard Frames and many other usage.



Installation

Flexible solutions for all types of safety barriers. Widest range of safety components, no weldings, so no hot permits required. No threading of bolting, so no special tools required. Cost effective to install as only low skilled workforce required.

PRODUCT CATALOG

01 Aluminum Alloy Material



Round Pipe clamps

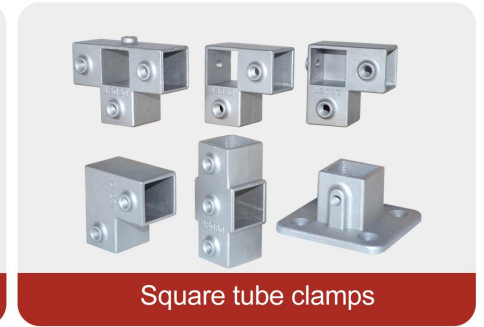

Square tube clamps

02 Cast iron material



Round pipe clamps



EIT Brand series



square tube clamps

03 Carbon Steel Material



Round Pipe clamps



Square Tube clamps

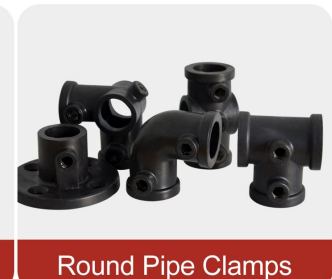

Round Pipe Clamps

04 PPR Material

ALUMINUM ALLOY

KEY CLAMP PIPE FITTINGS

Aluminum Alloy Round Pipe Clamps



The biggest advantage of aluminum alloy connector is that it greatly improves the mechanical strength and surface hardness of aluminum, and still maintains the inherent characteristics of light weight of aluminum, and its use value increases. In particular, after the diversified surface treatment of aluminum alloy, the beauty of aluminum alloy products is greatly improved. Product specification: 1/2 3/4 1

Pipe Size	Outside Diameter (mm)	Stainless steel top wire			Adaptive wrench	
		M8*10	M8*12	M8*10	M4	
1/2	20-21.3	 M8*20 M8*12 M8*10	M4			
3/4	25-26		M4			
1	32-33		M4			



101 Tee

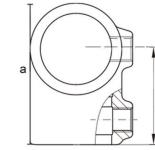

Nominal Bore	Outside Diameter (mm)	Product size		
		a	b	c
1/2	20-21.3	50	34	
3/4	25-26	60	42	
1	32-33	82	60	

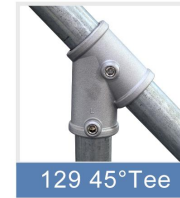

129 45° Tee

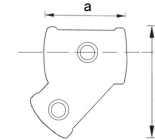

Nominal Bore	Outside Diameter (mm)	Product size		
		a	b	c
1/2	20-21.3			
3/4	25-26	50	67	
1	32-33			



125 Elbow

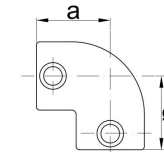

Nominal Bore	Outside Diameter (mm)	Product size		
		a	b	c
1/2	20-21.3	35		
3/4	25-26	38		
1	32-33	42		



128 3-Way

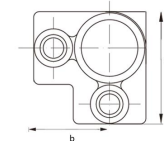

Nominal Bore	Outside Diameter (mm)	Product size		
		a	b	c
1/2	20-21.3	48	35	
3/4	25-26	60	40	
1	32-33	72	51	



116 4-Way

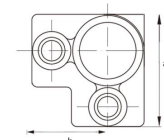

Nominal Bore	Outside Diameter (mm)	Product size		
		a	b	c
1/2	20-21.3	48	35	
3/4	25-26	60	40	
1	32-33	72	51	



104 Long Tee

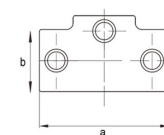

Nominal Bore	Outside Diameter (mm)	Product size		
		a	b	c
1/2	20-21.3	70	30	
3/4	25-26	80	35	
1	32-33	100	45	

ALUMINUM ALLOY

KEY CLAMP PIPE FITTINGS

Aluminum Alloy Round Pipe Clamps



119 Cross

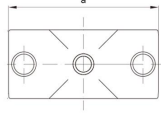

Nominal Bore	Outside Diameter (mm)	Product size		
		a	b	c
1/2	20-21.3	70		
3/4	25-26	80		
1	32-33	100		



131 Base Flange

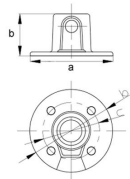

Nominal Bore	Outside Diameter (mm)	Product size		
		a	b	c
1/2	20-21.3	80	38	
3/4	25-26	80	40	
1	32-33	100	50	



176 5-Way

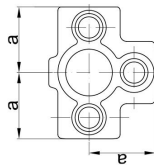

Nominal Bore	Outside Diameter (mm)	Product size		
		a	b	c
1/2	20-21.3	35		
3/4	25-26	43		
1	32-33	52		



Big 4-Way

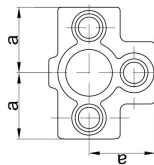

Nominal Bore	Outside Diameter (mm)	Product size		
		a	b	c
1/2	20-21.3	35		
3/4	25-26	43		
1	32-33	52		



149 Coupling

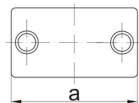

Nominal Bore	Outside Diameter (mm)	Product size		
		a	b	c
1/2	20-21.3	50		
3/4	25-26	60		
1	32-33	70		



149 Coupling with one screw hole

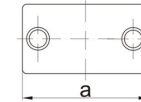

Nominal Bore	Outside Diameter (mm)	Product size		
		a	b	c
1/2	20-21.3	50		
3/4	25-26	60		
1	32-33	70		



Socket with 2 hole

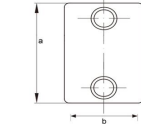

Nominal Bore	Outside Diameter (mm)	Product size		
		a	b	c
3/4	25-26	30	35	



Socket with one hole

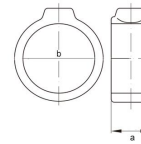

Nominal Bore	Outside Diameter (mm)	Product size		
		a	b	c
3/4	25-26	20	35	

Application

Can be used in: hangers, shelves, fish ponds, aquaculture ponds, billboards, agricultural gardens, all kinds of furniture, crafts and other frame structures, etc.

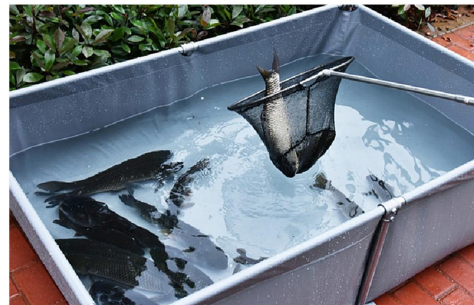

ALUMINUM PIPE FITTINGS

THREADED PIPE FITTINGS

Aluminum Alloy Thread Fittings



Tee

Nominal Bore	DN Size	Product size		
		a	b	c
1/2	DN15	35	45	
3/4	DN20	45	55	
1	DN25	50	65	



Elbow

Nominal Bore	DN Size	Product size		
		a	b	c
1/2	DN15	40	40	
3/4	DN20	43	43	
1	DN25	46	46	



Socket

Nominal Bore	DN Size	Product size		
		a	b	c
1/2	DN15	28	26	
3/4	DN20	32	30	
1	DN25	38	36	



Cap

Nominal Bore	DN Size	Product size		
		a	b	c
1/2	DN15	15		
3/4	DN20	17		
1	DN25	19		



3 holes flange

Nominal Bore	DN Size	Product size		
		a	b	c
1/2	DN15	65	14	
3/4	DN20	65	14	
1	DN25			



4 holes flange

Nominal Bore	DN Size	Product size		
		a	b	c
1/2	DN15	79	14	
3/4	DN20	79	14	
1	DN25	79	14	

Application

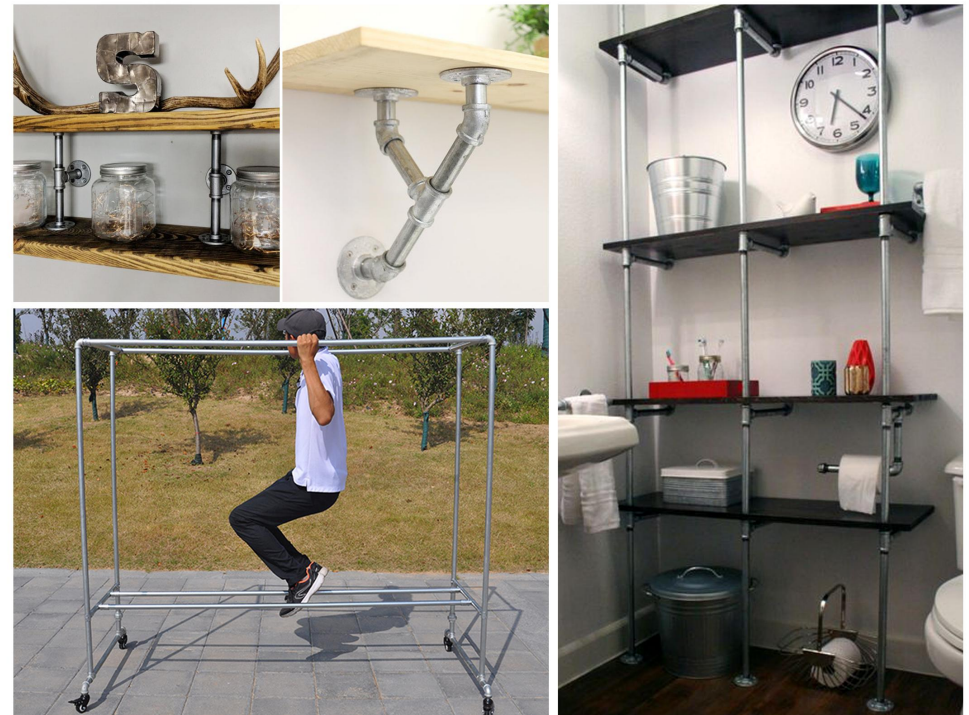

The following are only limited examples of a wide range of application scenarios

ALUMINUM ALLOY

KEY CLAMP PIPE FITTINGS

Aluminum Alloy Square Tube Clamps



In addition to the advantages of the round tube aluminum alloy, the square tube itself is a right Angle and has an Angle, so the shelf is more stable than the round tube, and the closed state can reach 100 kg.

Product specifications: 20* 20/25 * 25/30 *30



Product Specification	Outer Diameter (mm)	Stainless Steel Top Wire	Adaptive Wrench
20*20	20-21	M8*10	
25*25	25-26	M8*10	
30*30	30-31	M8*10	



101F Tee

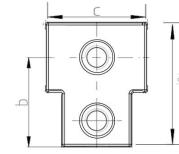

Nominal Bore	Outside Diameter (mm)	Product size		
		a	b	c
20*20	20-21	47	35	37
25*25	25-26	58	43	46
30*30	30-31	69	50	60



125F Elbow

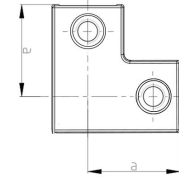

Nominal Bore	Outside Diameter (mm)	Product size		
		a	b	c
20*20	20-21	34		
25*25	25-26	43		
30*30	30-31	50		



128F 3 Way

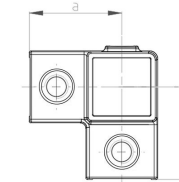

Nominal Bore	Outside Diameter (mm)	Product size		
		a	b	c
20*20	20-21	34		
25*25	25-26	43		
30*30	30-31	50		



116F 4 Way

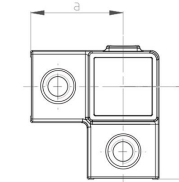

Nominal Bore	Outside Diameter (mm)	Product size		
		a	b	c
20*20	20-21	34		
25*25	25-26	43		
30*30	30-31	50		



131F Base flange

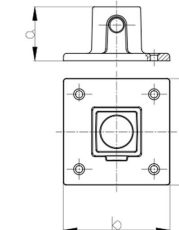

Nominal Bore	Outside Diameter (mm)	Product size		
		a	b	c
20*20	20-21	36	75	
25*25	25-26	41	80	
30*30	30-31	43	85	

ALUMINUM ALLOY

KEY CLAMP PIPE FITTINGS

Aluminum Alloy Square Tube Clamps



104F Long Tee

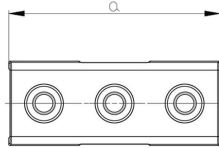

Nominal Bore	Outside Diameter (mm)	Product size		
		a	b	c
20*20	20-21	70		
25*25	25-26	84		
30*30	30-31	100		



119F Cross

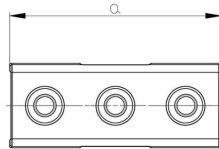

Nominal Bore	Outside Diameter (mm)	Product size		
		a	b	c
20*20	20-21	70		
25*25	25-26	84		
30*30	30-31	100		



176F 5 Way

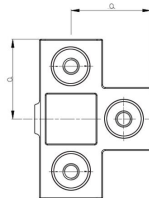

Nominal Bore	Outside Diameter (mm)	Product size		
		a	b	c
20*20	20-21	34		
25*25	25-26	43		
30*30	30-31			



Big 4 Way

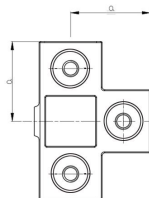

Nominal Bore	Outside Diameter (mm)	Product size		
		a	b	c
20*20	20-21	34		
25*25	25-26	43		
30*30	30-31			



149F Coupling

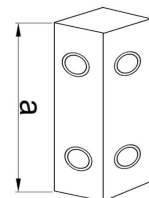

Nominal Bore	Outside Diameter (mm)	Product size		
		a	b	c
20*20	20-21	50		
25*25	25-26	60		
30*30	30-31	70		

ALUMINUM ALLOY

KYE CLAMP PIPE FITTINGS



149F Coupling with one screw hole

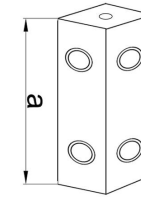

129F 45° Tee

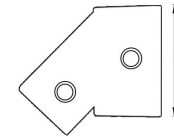

Nominal Bore	Outside Diameter (mm)	Product size		
		a	b	c
20*20	20-21	50		
25*25	25-26	60		
30*30	30-31	70		

Nominal Bore	Outside Diameter (mm)	Product size		
		a	b	c
20*20	20-21			
25*25	25-26			
30*30	30-31			

Application

Storage racks, shelves, tables and chairs, breeding cages, worktables, and other frame structures, a wide range of applications.

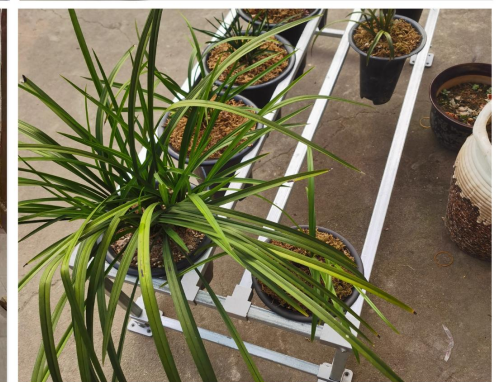

CAST IRON

KEY CLAMP PIPE FITTINGS

Premium Cast Iron Round Pipe Clamps



High-quality cast iron connectors with good mechanical properties and ductility. The surface of the frame product can be rust and corrosion resistant by standard hot dip galvanizing + electric galvanizing treatment. We can also customize hot plating, electroplating and black surface treatment according to customer requirements to adapt to different use environments.

Product specification: 1/2, 3/4, 1, 1 1/4, 1 1/2, 2

SIZE COMPARISON TABLE

Species	T	A	B	C	D	E
Specification	1/2	3/4	1	1-1/4	1-1/2	2
Dimension	4分	6分	1寸	1.2寸	1.5寸	2寸
Outside Diameter	≤21.3mm	≤26.9mm	≤33.7mm	≤42.4mm	≤48.3mm	≤60.3mm

* Using this form, the desired product can be easily identified between the customer and us

Additional surface treatment frame connectors can be customized

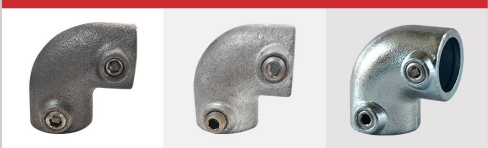

Black product

Hot dip galvanizing

Hot dip galvanizing + electric galvanizing



Top wire 1/8 Top wire 1/4 Top wire 3/8

Stainless steel top wire



m5/m6/m8 wrench

Adaptive wrench



CAST IRON

KEY CLAMP PIPE FITTINGS



APPLICATION EXAMPLES:

It is widely used in safety guardrail, fence, roof anti-fall guardrail, stair railings, playground equipment, fitness and running equipment, store decoration, shelves, drying racks, display racks, flower racks, shelving stage construction, barricade channels, billboards, signs, greenhouse, sunroom, garage, canopy, outdoor shelter, Diaoyutai, fish pond, indoor furniture tables, chairs, etc

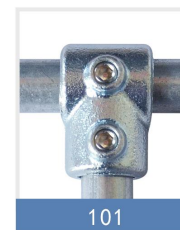

101

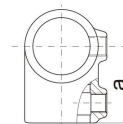

Size	Nominal Bore	Outside diameter (mm)	product size (mm)		
			a	b	c
T	1/2	21.3	35		
A	3/4	26.9	41		
B	1	33.7	46		
C	1-1/4	42.4	60		
D	1-1/2	48.3	68		
E	2	60.3	84		



104

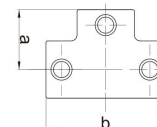

Size	Nominal Bore	Outside diameter (mm)	product size (mm)		
			a	b	c
T	1/2	21.3			
A	3/4	26.9	41	82	
B	1	33.7	46	92	
C	1-1/4	42.4	60	120	
D	1-1/2	48.3	98	136	
E	2	60.3	84	168	

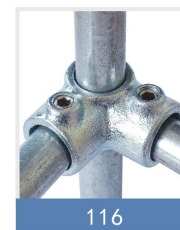

116

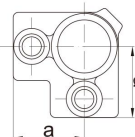

Size	Nominal Bore	Outside diameter (mm)	product size (mm)		
			a	b	c
T	1/2	21.3	35		
A	3/4	26.9	40		
B	1	33.7	48		
C	1-1/4	42.4	60		
D	1-1/2	48.3	68		
E	2	60.3	86		



119

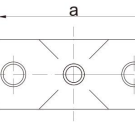

Size	Nominal Bore	Outside diameter (mm)	product size (mm)		
			a	b	c
T	1/2	21.3	70		
A	3/4	26.9	80		
B	1	33.7	96		
C	1-1/4	42.4	120		
D	1-1/2	48.3	136		
E	2	60.3	168		

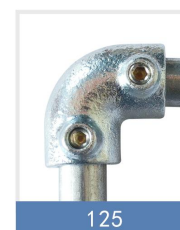

125

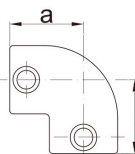

Size	Nominal Bore	Outside diameter (mm)	product size (mm)		
			a	b	c
T	1/2	21.3	35		
A	3/4	26.9	41		
B	1	33.7	46		
C	1-1/4	42.4	60		
D	1-1/2	48.3	68		
E	2	60.3	84		

Premium Cast Iron Round Pipe Clamps



128

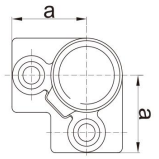

Size	Nominal Bore	Outside Diameter (mm)	Product size (mm)		
			a	b	c
T	1/2	21.3			
A	3/4	26.9			
B	1	33.7			
C	1-1/4	42.4			
D	1-1/2	48.3			



138

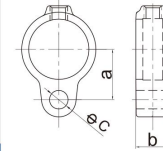

Size	Nominal Bore	Outside Diameter (mm)	Product size (mm)		
			a	b	c
A	3/4	26.9	30	25	14
B	1	33.7	33	25	14
C	1-1/4	42.4	38	25	14
D	1-1/2	48.3	41	25	14



140

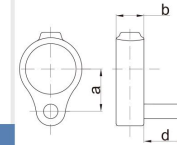

Size	Nominal Bore	Outside Diameter (mm)	Product size (mm)			
			a	b	c	d
A	3/4	26.9	30	25	13	38
B	1	33.7	33	25	13	38
C	1-1/4	42.4	38	25	12	38
D	1-1/2	48.3	41	25	12	38



129

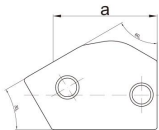

Size	Nominal Bore	Outside Diameter (mm)	Product size (mm)		
			a	b	c
A	3/4	26.9	75		
B	1	33.7	70		
C	1-1/4	42.4	85		
D	1-1/2	48.3	90		



143

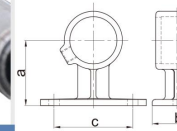

Size	Nominal Bore	Outside Diameter (mm)	Product size (mm)		
			a	b	c
A	3/4	26.9	55	44	57
B	1	33.7	57	44	62
C	1-1/4	42.4	63	44	76
D	1-1/2	48.3	67	50	82.5



131

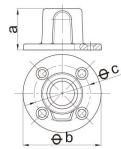

Size	Nominal Bore	Outside Diameter (mm)	Product size (mm)		
			a	b	c
T	1/2	21.3	32	74	55.5
A	3/4	26.9	42	83	57
B	1	33.7	48	89	65
C	1-1/4	42.4	50	102	76
D	1-1/2	48.3	59	114	88.5
E	2	60.3	64	127	95

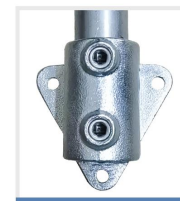

146

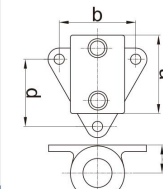

Size	Nominal Bore	Outside Diameter (mm)	Product size (mm)			
			a	b	c	d
B	1	33.7	76	71	24	63
C	1-1/4	42.4	83	82	28	72
D	1-1/2	48.3	89	86	31	78



132

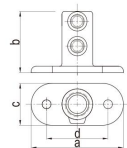

Size	Nominal Bore	Outside Diameter (mm)	Product size (mm)			
			a	b	c	d
A	3/4	26.9	105	65	52	76
B	1	33.7	125	73	60	89
C	1-1/4	42.4	138	88	70	101
D	1-1/2	48.3	150	95	80	114
E	2	60.3	170	102	92	127

CAST IRON

KEY CLAMP PIPE FITTINGS

Premium Cast Iron Round Pipe Clamps

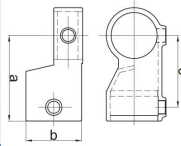
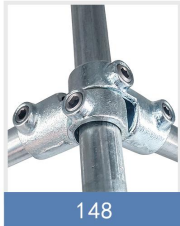

Size	Nominal Bore	Outside Diameter (mm)	Product size(mm)		
			a	b	c
A	3/4	26.9	53	37	42
B	1	33.7	59	46	48
C	1-1/4	42.4	73	55	58.5
D	1-1/2	48.3	93	60.5	78
E	2	60.3	110	73	93.5

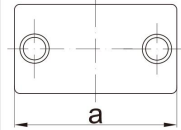

Size	Nominal Bore	Outside Diameter (mm)	Product size(mm)		
			a	b	c
T	1/2	21.3			
A	3/4	26.9	76		
B	1	33.7	89		
C	1-1/4	42.4	102		
D	1-1/2	48.3	102		
E	2	60.3	120		

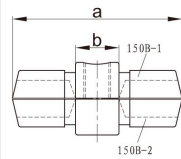

Size	Nominal Bore	Outside Diameter (mm)	Product size(mm)		
			a	b	c
A	3/4	26.9	76	22	
B	1	33.7	78	20	
C	1-1/4	42.4	78	20	
D	1-1/2	48.3	78	20	

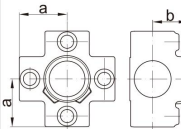
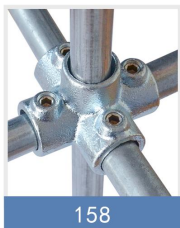

Size	Nominal Bore	Outside Diameter (mm)	Product size(mm)		
			a	b	c
T	1/2	21.3	35	35	
A	3/4	26.9	41	32	
B	1	33.7	46	35	
C	1-1/4	42.4	60	43.5	
D	1-1/2	48.3	68	49.5	

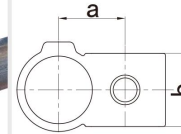
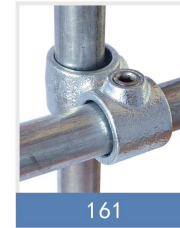

Size	Nominal Bore	Outside Diameter (mm)	Product size(mm)		
			a	b	d
A	3/4	26.9	38	31.5	
B	1	33.7	41	38.5	
C	1-1/4	42.4	50	45	
D	1-1/2	48.3	50	55	
E	2	60.3	64	61	

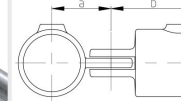
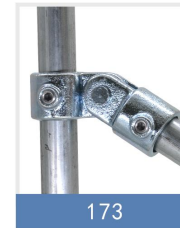

Size	Nominal Bore	Outside Diameter (mm)	Product size(mm)		
			a	b	c
A	3/4	26.9	38	58.5	
B	1	33.7	43.5	61	
C	1-1/4	42.4	47	69	
D	1-1/2	48.3	53	77	
E	2	60.3	62	90.5	

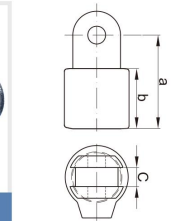

Size	Nominal Bore	Outside Diameter (mm)	Product size(mm)		
			a	b	c
A	3/4	26.9	61	38	11.2
B	1	33.7	61	38	11.2
C	1-1/4	42.4	69	46	11.2
D	1-1/2	48.3	77	55	11.2
E	2	60.3	90.5	63	11.2

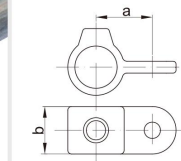

Size	Nominal Bore	Outside Diameter (mm)	Product size(mm)		
			a	b	c
A	3/4	26.9	40	38	
B	1	33.7	43.5	38	
C	1-1/4	42.4	48	44.5	
D	1-1/2	48.3	53	44.5	
E	2	60.3	62	50.5	

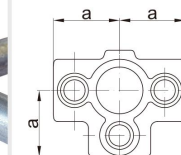

Size	Nominal Bore	Outside Diameter (mm)	Product size(mm)		
			a	b	c
T	1/2	21.3	35		
A	3/4	26.9	40		
B	1	33.7	46		
C	1-1/4	42.4	60		
D	1-1/2	48.3	68		
E	2	60.3	84.5		

CAST IRON

KEY CLAMP PIPE FITTINGS

Premium Cast Iron Round Pipe Clamps



185

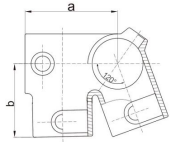

Size	Nominal Bore	Outside diameter (mm)	Product size (mm)		
			a	b	c
A	3/4	26.9	55	60	
B	1				
C	1-1/4		95	78	
D	1-1/2	48.3	99	87	



191

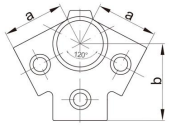

Size	Nominal Bore	Outside diameter (mm)	Product size (mm)		
			a	b	c
A	3/4	26.9	52	30	
B	1				
C	1-1/4		72.3	36	
D	1-1/2	48.3		16.5	



198

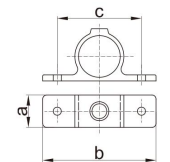

Size	Nominal Bore	Outside diameter (mm)	Product size (mm)		
			a	b	c
A	3/4	26.9	35	128	94
B	1	33.7	30	120	86
C	1-1/4	42.4	33	130	95
D	1-1/2	48.3	35	140	104



149M

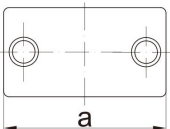

Size	Nominal Bore	Outside diameter (mm)	Product size (mm)		
			a	b	c
T	1/2	21.3			
B	1	33.7			
C	1-1/4	42.4			

Application

The following are only limited examples of a wide range of application scenarios

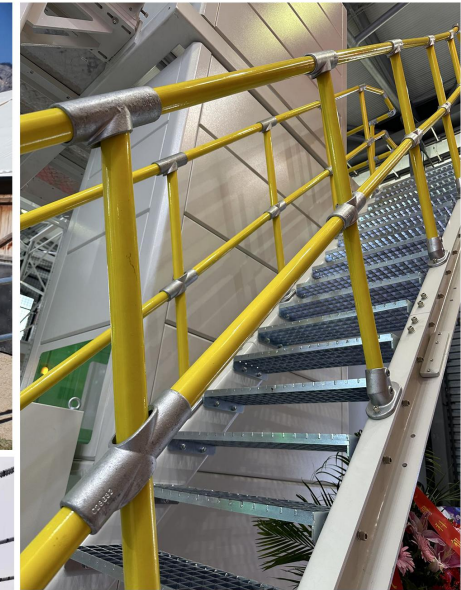

CAST IRON

KEY CLAMP PIPE FITTINGS

EIT Brand Round Pipe Clamps

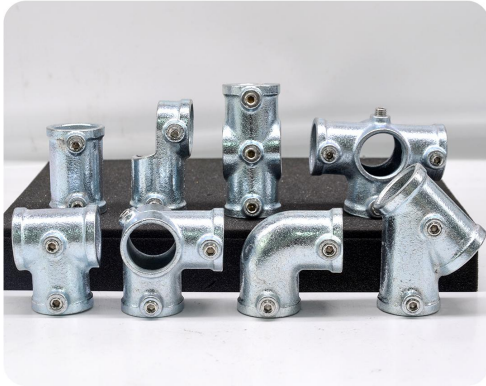

Cast iron:

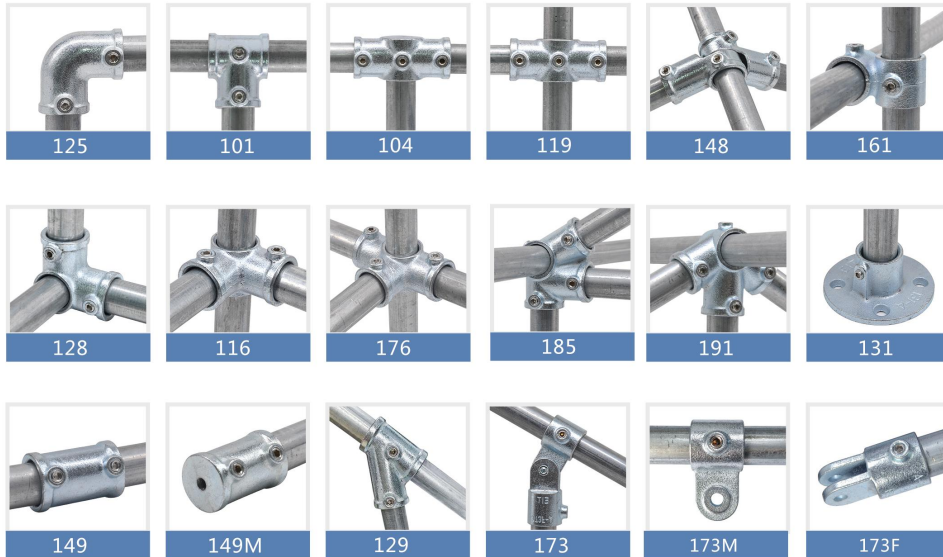

The biggest advantage of cast iron material is good mechanical properties and ductility. The surface of the frame products can be treated by electroplating to prevent rust and corrosion. Can also be customized according to customer requirements, hot plating, black products, electroplating surface treatment, to adapt to different use environment

Product specifications: 1/2, 3/4, 1, 1 1/4, 1 1/2



* Need other sizes, can be customized, can be opened mold.

SIZE COMPARISON TABLE

Specification	1/2	3/4	1	1-1/4	1-1/2
Applicable pipe	20-21.3mm	25-26.2mm	32-33mm	42-42.4mm	48-48.3mm
Pushing thread	 Stainless steel top wire		M4 wrench		

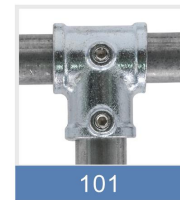

101

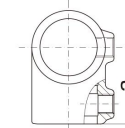

Nominal bore	Product size		
	a	b	c
1/2	34		
3/4	47		
1	50		
1-1/4	60		
1-1/2	68		



125

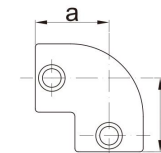

Nominal bore	Product size		
	a	b	c
1/2	34		
3/4	41		
1	50		
1-1/4	60		
1-1/2	68		



104

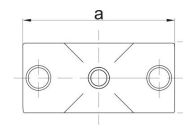

Nominal bore	Product size		
	a	b	c
1/2	80	30	
3/4	80	36	
1	80	44	
1-1/4	120	60	
1-1/2	136	98	

CAST IRON

KEY CLAMP PIPE FITTINGS

EIT Brand Round Pipe Clamps

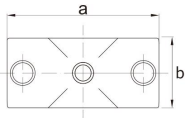

Nominal Bore	Product size		
	a	b	c
1/2	80	30	
3/4	80	36	
1	80	44	
1-1/4	120		
1-1/2	136		

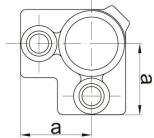

Nominal Bore	Product size		
	a	b	c
1/2	34		
3/4	40		
1	50		
1-1/4			
1-1/2			

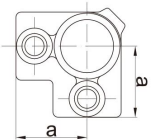

Nominal Bore	Product size		
	a	b	c
1/2	34		
3/4	40		
1	50		
1-1/4	60		
1-1/2	68		

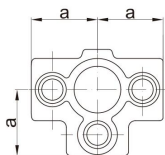

Nominal Bore	Product size		
	a	b	c
1/2	34		
3/4	40		
1	50		
1-1/4	60		
1-1/2	68		

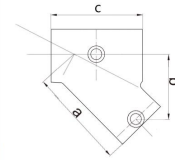

Nominal Bore	Product size		
	a	b	c
1/2	69	31	50
3/4	66	43	54
1	69	47	70
1-1/4			
1-1/2			

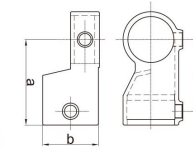

Nominal Bore	Product size		
	a	b	c
1/2	44	30	36
3/4	52	35	44
1	62	44	54
1-1/4	73	55	58.5
1-1/2	93	60.5	78

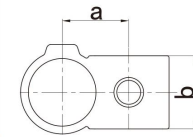

Nominal Bore	Product size		
	a	b	c
1/2		32	
3/4	31	32	
1		32	
1-1/4	50	45	
1-1/2	50	55	

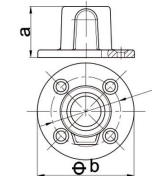

Nominal Bore	Product size		
	a	b	c
1/2	30	80	
3/4	36	84	
1	35	85	
1-1/4	50	102	
1-1/2	59	114	

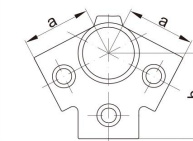

Nominal Bore	Product size		
	a	b	c
1/2	54	50	
3/4	40	50	
1	54	70	
1-1/4	72.3	81.5	
1-1/2			

CAST IRON

KEY CLAMP PIPE FITTINGS

EIT Brand Round Pipe Clamps



185

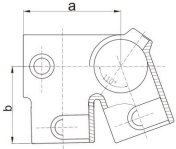

Nominal Bore	Product size		
	a	b	c
1/2	54	41	
3/4	42	42	
1	54	57	
1-1/4	95	78	
1-1/2	99	87	



173

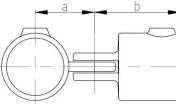

Nominal Bore	Product size		
	a	b	c
1/2	40	42	
3/4	39	53	
1	61	62	
1-1/4	53	77	
1-1/2	62	90.5	



173M

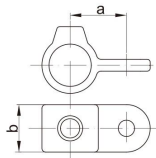

Nominal Bore	Product size		
	a	b	c
1/2	40	32	
3/4	38	33	
1	61	32	
1-1/4	53	44.5	
1-1/2	62	50.5	



173F

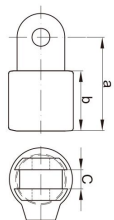

Nominal Bore	Product size		
	a	b	c
1/2	42	26	9
3/4	53	33	9
1	62	39	9
1-1/4	77	55	11.2
1-1/2	90.5	63	11.2



149

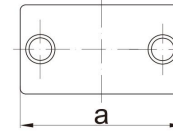

Nominal Bore	Product size		
	a	b	c
1/2	50		
3/4	53		
1	70		
1-1/4	102		
1-1/2	102		



149M

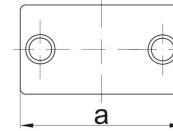

Nominal Bore	Product size		
	a	b	c
1/2	50		
3/4	53		
1	70		
1-1/4	42.4		
1-1/2			

Application

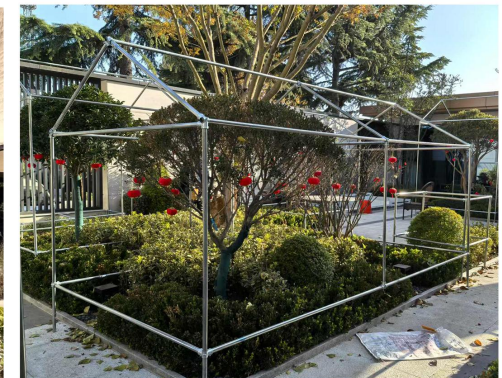

CAST IRON

KEY CLAMP PIPE FITTINGS

ALUMINUM ALLOY

KEY CLAMP PIPE FITTINGS

Premium Cast Iron Square Tube Clamps



Advantages of cast iron: The biggest advantage of cast iron material has good mechanical properties and ductility. The surface of the frame products can be rust and corrosion resistant after hot dip galvanizing + electroplating treatment. Can also be customized according to customer requirements, hot plating, black products, electroplating surface treatment, to adapt to different use environment.

Product specifications:
20*20/25*25/30*30/40*40(mm)



SIZE COMPARISON TABLE

Specification	20*20	25*25	30*30	40*40
Outside Diameter	20-21mm	25-26mm	30-31mm	40-42mm
Stainless steel top wire				Fitting top wire
				M5/m6/m8 wrench

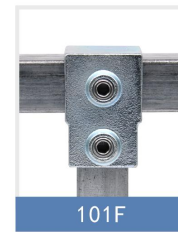

101F

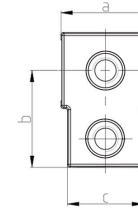

Nominal Bore	Outside Diameter (mm)	Size (mm)		
		a	b	c
20*20	20-21	35		23
25*25	25-26	41		37
30*30	30-31	50		43
40*40	40-42	59		53

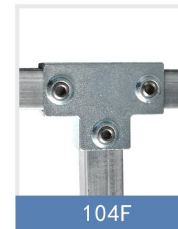

104F

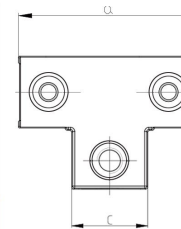

Nominal Bore	Outside Diameter (mm)	Size (mm)		
		a	b	c
20*20	20-21			23
25*25	25-26			37
30*30	30-31			43
40*40	40-42			53



116F

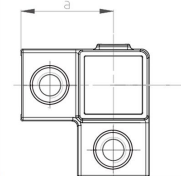

Nominal Bore	Outside Diameter (mm)	Size (mm)		
		a	b	c
20*20	20-21			
25*25	25-26	42		
30*30	30-31	47		
40*40	40-42	61		



119F

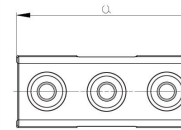

Nominal Bore	Outside Diameter (mm)	Size (mm)		
		a	b	c
20*20	20-21	72		
25*25	25-26	84		
30*30	30-31	93		
40*40	40-42	122		



125F

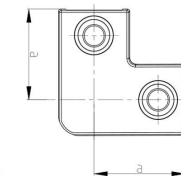

Nominal Bore	Outside Diameter (mm)	Size (mm)		
		a	b	c
20*20	20-21			
25*25	25-26	42		
30*30	30-31	47		
40*40	40-42	61		

CAST IRON

KEY CLAMP PIPE FITTINGS

Premium Cast Iron Square Tube Clamps

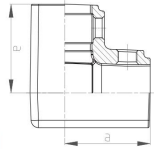

Nominal Bore	Outside Diameter (mm)	Size (mm)		
		a	b	c
20*20	20-21			
25*25	25-26	42		
30*30	30-31	47		
40*40	40-42	61		

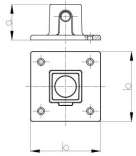

Nominal Bore	Outside Diameter (mm)	Size (mm)		
		a	b	c
20*20	20-21		75	
25*25	25-26		83	
30*30	30-31		89	
40*40	40-42		102	

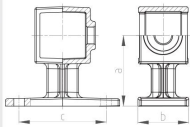

Nominal Bore	Outside Diameter (mm)	Size (mm)		
		a	b	c
20*20	20-21			
25*25	25-26			
30*30	30-31			
40*40	40-42			

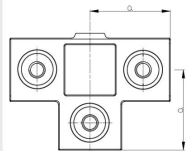

Nominal Bore	Outside Diameter (mm)	Size (mm)		
		a	b	c
20*20	20-21			
25*25	25-26			
30*30	30-31			
40*40	40-42	61		

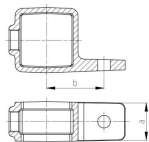

Nominal Bore	Outside Diameter (mm)	Size (mm)		
		a	b	c
20*20	20-21			
25*25	25-26			
30*30	30-31			
40*40	40-42			

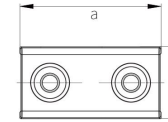

Nominal Bore	Outside Diameter (mm)	Size (mm)		
		a	b	c
20*20	20-21			
25*25	25-26			
30*30	30-31			
40*40	40-42	109	53	

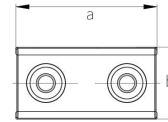

Nominal Bore	Outside Diameter (mm)	Size (mm)		
		a	b	c
20*20	20-21			
25*25	25-26			
30*30	30-31			
40*40	40-42	109	53	

Application



CARBON STEEL

KEY CLAMP PIPE FITTINGS

Carbon Steel Round Pipe Clamps



Clamping piece, open connection, carbon steel material, reinforcement without disassembling the original structure, easy installation, low cost. This product adopts mortise and tenon design, so that the joints between the members are compatible, can withstand large loads, allow a certain deformation, so as to form an elastic frame and the connecting parts are equipped with circular holes, allowing the harsh conditions and pipes to be reinforced again to ensure the stability of the structure.



SIZE COMPARISON TABLE			
Nominal Bore	20	25	32
Diameter(mm)	21	26	33
Adaptor screw	M5*22	M6*25	M6*35
Adaptive wrench	M4	M5	M5

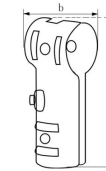

Nominal Bore	Outside Diameter (mm)	Size(mm)		
		a	b	c
20	21	70	25	
25	26	77	30	
32	33	89	37	

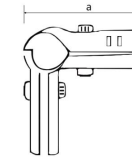

Nominal Bore	Outside Diameter (mm)	Size(mm)		
		a	b	c
20	21	70		
25	26	76		
32	33	90		

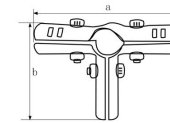

Nominal Bore	Outside Diameter (mm)	Size(mm)		
		a	b	c
20	21	116	68	
25	26	125	78	
32	33	140	90	

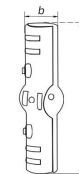

Nominal Bore	Outside Diameter (mm)	Size(mm)		
		a	b	c
20	21	117		
25	26	125		
32	33	140		

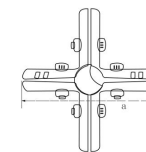

Nominal Bore	Outside Diameter (mm)	Size(mm)		
		a	b	c
20	21	116		
25	26	125		
32	33	136		

CARBON STEEL

KEY CLAMP PIPE FITTINGS

Carbon Steel Round Pipe Clamps



Elbow

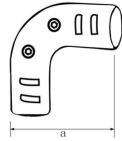

Nominal Bore	Outside Diameter (mm)	Size(mm)		
		a	b	c
20	21	72		
25	26	80		
32	33	87		



Bilateral

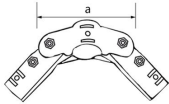

Nominal Bore	Outside Diameter (mm)	Size(mm)		
		a	b	c
20	21			
25	26	99		
32	33			



Swivel tee

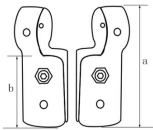

Nominal Bore	Outside Diameter (mm)	Size(mm)		
		a	b	c
20	21			
25	26	76	28	
32	33			



Parallel



Nominal Bore	Outside Diameter (mm)	Size(mm)		
		a	b	c
20	21			
25	26			
32	33			



Swivel Joint



Nominal Bore	Outside Diameter (mm)	Size(mm)		
		a	b	c
20	21			
25	26	78	29	
32	33			

Application

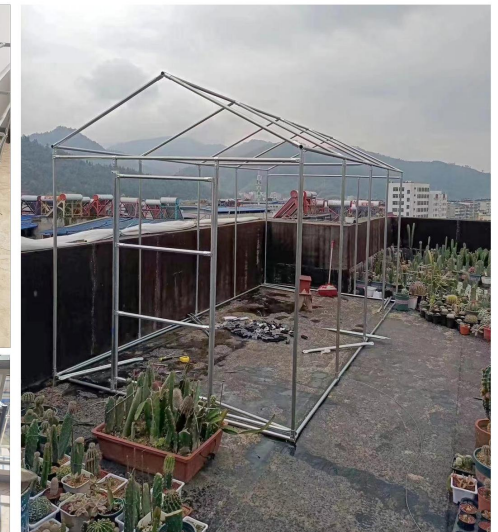
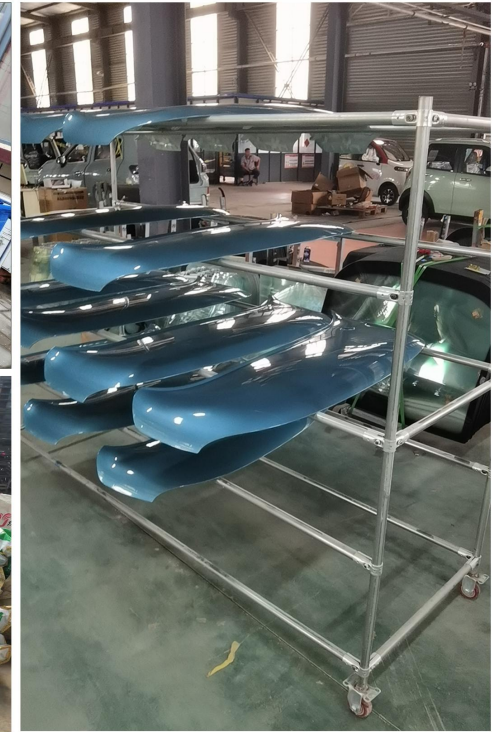

CARBON STEEL

KEY CLAMP PIPE FITTINGS

Carbon Steel Square Tube Clamps

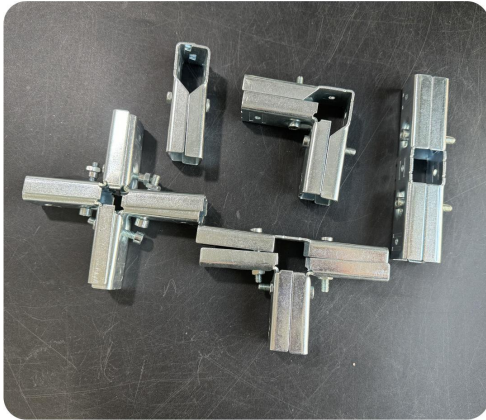

Clamping piece, open connection, carbon steel material, reinforcement without disassembling the original structure, easy installation, low cost.

This product adopts mortise and tenon design, so that the joints between the members are compatible, can withstand large loads, allow a certain deformation, so as to form an elastic frame and the connecting parts are equipped with circular holes, allowing the harsh conditions and pipes to be reinforced again to ensure the stability of the structure.



SIZE COMPARISON TABLE			
Nominal Bore	Diameter(mm)	Adaptor screw	Adaptive wrench
25*25	25*25	M6*28	M5

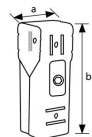

Nominal Bore	Outside Diameter (mm)	Size (mm)		
		a	b	c
25*25	25*25		85	

The dimensions are manual measurement, there is 1-2mm error, for reference only, the specific object shall prevail

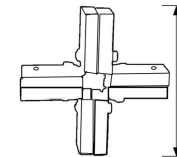
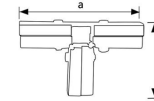
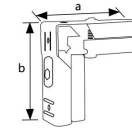

Nominal Bore	Outside Diameter (mm)	Size (mm)		
		a	b	c
25*25	25*25	85	85	

Nominal Bore	Outside Diameter (mm)	Size (mm)		
		a	b	c
25*25	25*25	140	80	

Nominal Bore	Outside Diameter (mm)	Size (mm)		
		a	b	c
25*25	25*25		140	

Nominal Bore	Outside Diameter (mm)	Size (mm)		
		a	b	c
25*25	25*25	130	130	

Application

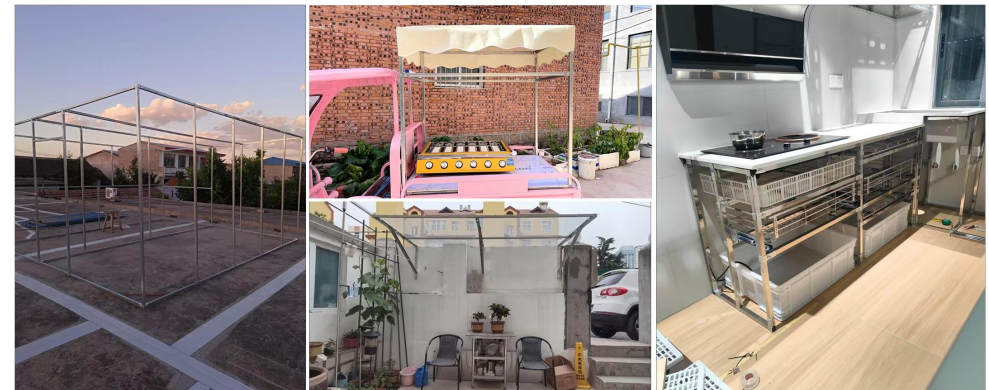

CARBON STEEL

KEY CLAMP PIPE FITTINGS

Carbon Steel Square Tube Clamps

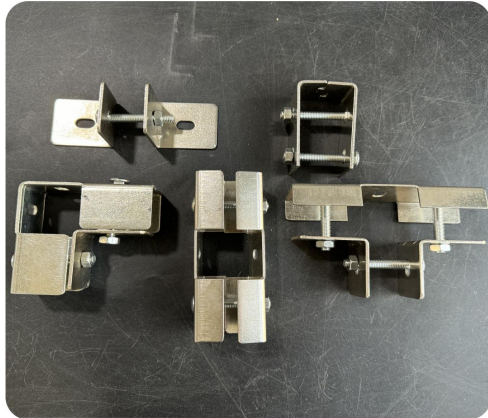

Clamping piece connector, open connection, carbon steel material, reinforcement without disassembling the original structure, large size pipe drilling, closely connected with pipe fittings, strong and reliable.

This product adopts mortise and tenon design, so that the joints between the components are consistent, can withstand large loads, allow a certain deformation, thus forming an elastic frame, and the above with a round hole and the round hole on the square pipe are closely connected through the carriage bolt, strong and non-shaking.



4 Way



5 Way



Cross tee

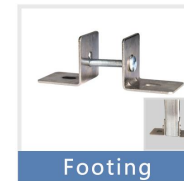

Footing

Nominal Bore	Outside Diameter (mm)	Size (mm)		
		a	b	c
40*40	40*40	90	90	

Nominal Bore	Outside Diameter (mm)	Size (mm)		
		a	b	c
40*40	40*40	140	100	

Nominal Bore	Outside Diameter (mm)	Size (mm)		
		a	b	c
40*40	40*40		140	

Nominal Bore	Outside Diameter (mm)	Size (mm)		
		a	b	c
40*40	40*40	50	140	



Tee

4 Way

5 Way

Cross tee

Footing

SIZE COMPARISON TABLE

Nominal Bore	Diameter(mm)	Adaptor screw	Adaptive wrench
40*40	40*40	M8*55	M13



Buggy bolt

Hexagonal wrench



Tee

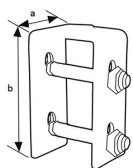

Nominal Bore	Outside Diameter (mm)	Size (mm)		
		a	b	c
40*40	40*40	45	77	

Application



The dimensions are manual measurement, there is 1-2mm error, for reference only, the specific object shall prevail

PPR ROUND PIPE FITTINGS

KEY CLAMP PIPE FITINGS

PPR Round Pipe Clamps



PPR has excellent corrosion resistance, also shows good thermal stability, can with stand long-term use at higher temperatures; Its light weight, easy to carry and install characteristics, reduce the burden on the shelf structure; PPR pipe has strong service life, good impact strength and toughness, and is not easy to break and damage. It is one of the indispensable materials in modern engineering.

Product specification: ¾



Adapter outer diameter (mm) 6 points (¾) for pipes ≤26.5mm

M8*15 top silk	M4 wrench

PPR frame connector is suitable for pipe diameter

125 Elbow

Nominal Bore	Outside Diameter (mm)	Size(mm)		
		a	b	c
¾	25-26mm	43		

101 Tee

Nominal Bore	Outside Diameter (mm)	Size(mm)		
		a	b	c
¾	25-26mm	62	43	

131 Base flange

Nominal Bore	Outside Diameter (mm)	Size(mm)		
		a	b	c
¾	25-26mm	83	42	

104 Long tee

Nominal Bore	Outside Diameter (mm)	Size(mm)		
		a	b	c
¾	25-26mm	78	40	

128 3 Way

Nominal Bore	Outside Diameter (mm)	Size(mm)		
		a	b	c
¾	25-26mm	66	43	

Big 4 Way

Nominal Bore	Outside Diameter (mm)	Size(mm)		
		a	b	c
¾	25-26mm	46		

119 Cross

Nominal Bore	Outside Diameter (mm)	Size(mm)		
		a	b	c
¾	25-26mm	78		

116 4 Way

Nominal Bore	Outside Diameter (mm)	Size(mm)		
		a	b	c
¾	25-26mm	66	43	

176 5 Way

Nominal Bore	Outside Diameter (mm)	Size(mm)		
		a	b	c
¾	25-26mm	46		

Application

